

Features

- Low insertion loss
- High channel isolation
- Low polarization dependent loss
- Exceptional reliability and stability



Applications

- Access networks
- Metro WDM systems
- Enterprise networks

Product Description

Primanex's Coarse Wavelength Division Multiplexers (CWDMs) demonstrate low loss and reliable performance. These devices show broad passband and high isolation, making them ideal for operation with inexpensive, uncooled lasers, thereby enabling high capacity, low cost products for the CATV and metro/access markets.

Easily customizable, Primanex CWDMs can be configured from a standard list of packaging and connector options.

Specifications

Item	Unit	Parameters		Notes
Channel Spacing		20 nm ITU grids		
Wavelength Range	nm	1460 to 1620	1260 to 1620	
Channel Centers (ITU or ITU+1)	nm	1470/1490...1610 or 1471/1491...1611	1270/1290...1610 or 1271/1291...1611	
Passband	nm	≥ +/- 7		
Passband Ripple	dB	≤ 0.3		
Add/Drop Insertion Loss (single-λ)	dB	≤ 1.0 dB		
Add/Drop Insertion Loss (dual-λ)	dB	≤ 1.8dB		
Express Insertion Loss (single-λ)	dB	≤ 0.8 dB		
Express Insertion Loss (dual-λ)	dB	≤ 1.3 dB		
Drop Isolation (adj channel)	dB	≥ 30 dB		
Drop Isolation (non-adj channel)	dB	≥ 50 dB		
Express Isolation	dB	≥ 25 dB		
Polarization Dependent Loss	dB	≤ 0.2 dB		
Polarization Mode Dispersion	ps	≤ 0.2 ps		
Directivity	dB	≥ 50 dB		
Return Loss	dB	≥ 45 dB		
Optical Power Handling	mW	≤ 500		
Operating Temperature Range	°C	-5 to 70		
Storage Temperature Range	°C	-40 to +85		
Fiber Type	NA	SMF-28e+		
Package Dimension	mm	100×80×10		ABS

*. All the specifications are based on the devices without connectors, and guaranteed over wavelength, polarization and temperature.

** Specifications are subject to change without notice.

Add: Rm#802, Bldg#57, Qingdao Optics Valley International Marine Information Port 396 Emei Rd, Qingdao Economics & Technology Development Zone, Shandong 266555, China.

Website: WWW.Primanex.com.cn

Tel: +86-532-8695 9098 Fax: +86-532-8676 8589

Email: Sales@primanex.com.cn

Dimensions Drawing (Unit: mm)

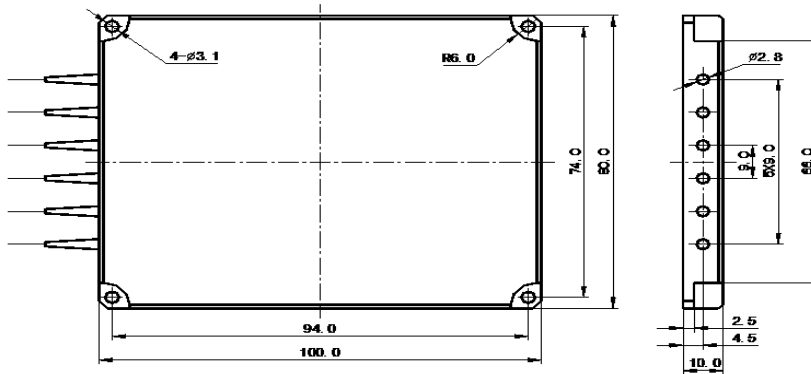

Spectral Plot (Unit: dB)

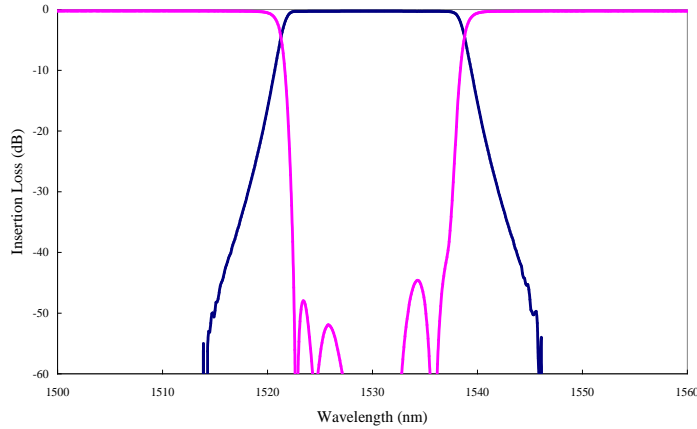

Ordering Information (Sample: ADMC-0F53010120)

ADMC-	<input type="checkbox"/>	F	<input type="checkbox"/>	<input type="checkbox"/>	<input type="checkbox"/>	<input type="checkbox"/>	<input type="checkbox"/>	<input type="checkbox"/>
Code Channel Plan		Channel Frequency		Code Channel Number		Fiber Length		Connector Type
0. ITU		Provided by Primanex upon customer confirmation		101. Single Channel		1. 0.5 +/- 0.1 m		0. No Connector
1. ITU+1				202. Dual Channel		2. 1.0 +/- 0.1 m		1. FC/UPC
				909. Custom		3. Others		2. FC/APC
								3. SC/UPC
								4. SC/APC
								5. Others

All statements, technical information and recommendations related to the products herein are based upon information believed to be reliable or accurate. However, the accuracy or completeness thereof is not guaranteed, and no responsibility is assumed for any inaccuracies. The user assumes all risks and liability whatsoever in connection with the use of a product or its application. Primanex reserves the right to change at any time without notices the design, specifications, function, fit or form of its products described herein, including withdrawal at any time of a product offered for sale herein. Primanex makes no representations that the products herein are free from any intellectual property claims of others. Please contact Primanex for more information. Primanex and the Primanex logo are trademarks of Primanex Corporation. Other trademarks are the property of their respective holders.